

# ASSEMBLY INSTRUCTIONS

## STABILIZER ASSEMBLY

1. Remove nut 'A'. Make sure that the bolt does not fall out of the square hole.
2. Place the cranked end of the stabilizer bracket over 'B', secure with the nut which should be hand tightened first before using the spanner. 3 complete turns should be sufficient to fully tighten the nut. (Recommended tightening torque 10-12Nm).

### Note:

It is important that the head of the bolt is tight up against the inside of the frame plate.

### Note:

Both stabilizer wheels should not touch the ground at the same time as these are used for 'training' purposes.

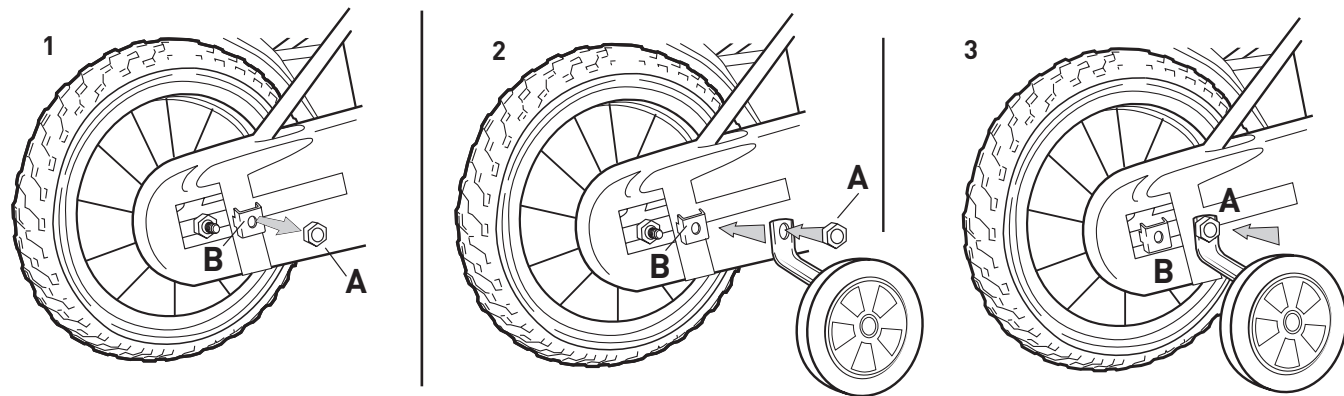
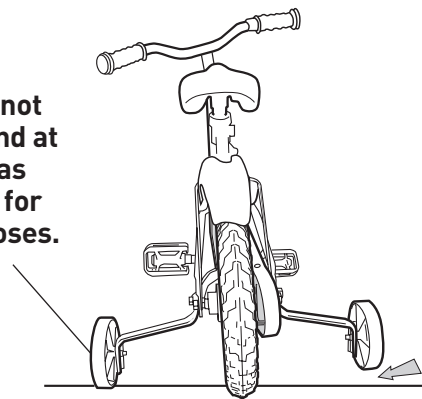

## SADDLE HEIGHT ADJUSTMENT

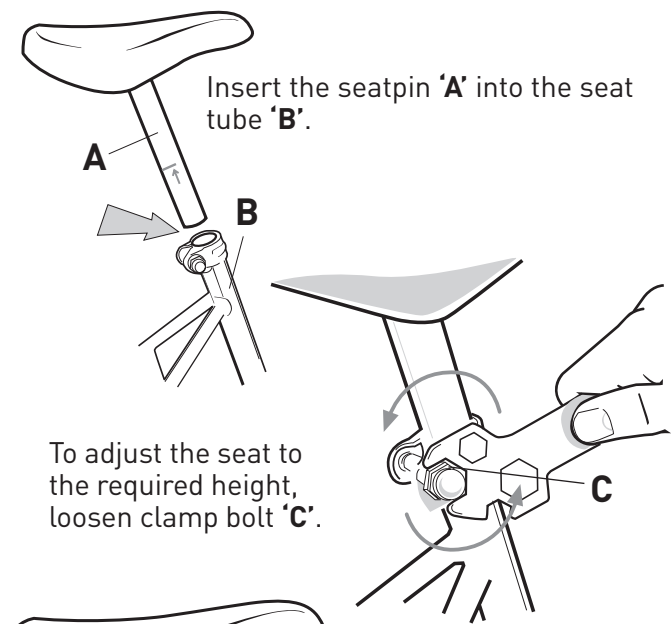

To adjust the seat to the required height, loosen clamp bolt 'C'.

Recommended tightening torque 10-12Nm

**NOTE:** DO NOT RAISE THE SADDLE PIN PAST THE STOP MARK INDICATED ON SEAT PIN

## ATTACHING THE PEDALS

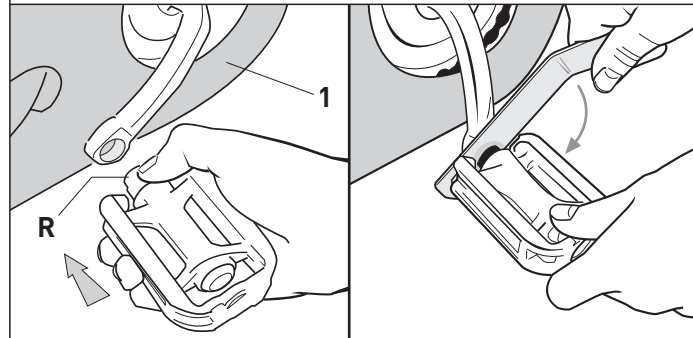

**IMPORTANT: ENSURE THAT THE PEDALS ARE FULLY TIGHT AND CHECK AT REGULAR INTERVALS.**

With the bicycle positioned so that the chainguard '1' is facing you, select the pedal that is marked 'R' (marked on end of thread).

Screw the pedal **CLOCKWISE** into the right hand crank, turn the pedal by hand to avoid cross threading. Tighten securely, using the spanner supplied.

Turn the bicycle round, repeat the above procedure for the left hand pedal, marked 'L' (marked on end of thread). Tighten **ANTI-CLOCKWISE**.

## HANDLEBAR ASSEMBLY

There are two types of handlebar attachment in general use.

### Stem Type (Single Allen Bolt)

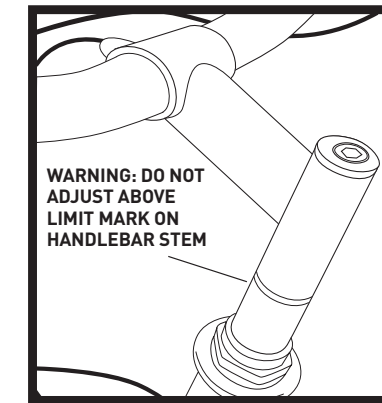

1 Loosen the bolt using the 6mm allen key.

2 Turn the handlebar and set at 90 degrees to the front wheel. Set at the required height and re-tighten the bolt.

**Important: Do not position the stem outside the limit mark.**

### Stem Type (Single Hexagon Bolt)

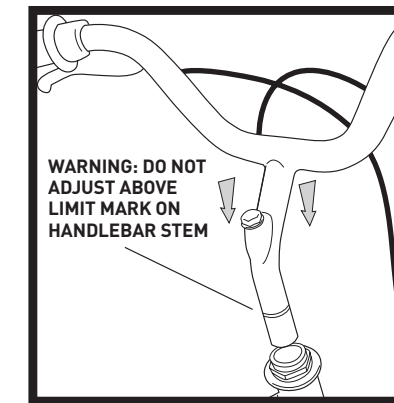

1 Loosen the bolt using the spanner.

2 Turn the handlebar and set at 90 degrees to the front wheel. Set at the required height and re-tighten the bolt.

**Important: Do not position the stem outside the limit mark.**

## MAINTENANCE & USER INFORMATION

Additional tools may be required for maintenance, such as a Phillips screwdriver, spanner and pliers.

### REAR WHEEL ADJUSTMENT

If the wheel wobbles, slacken off the outer nut 'C', adjust the inner nut 'E' to take up the play on the axle, ensure free running of the wheel. Tighten locknut 'D' onto nut 'E' finally tighten nut 'C' onto frame.

If the wheel is stiff to turn, slacken off outer wheel nut 'C' loosen locking nut 'D' and adjust nut 'E' to ensure free running of wheel. Tighten locking nut 'D' onto 'E' and finally tighten outer nut 'C' onto frame. Recommended tightening torque 20-22Nm.

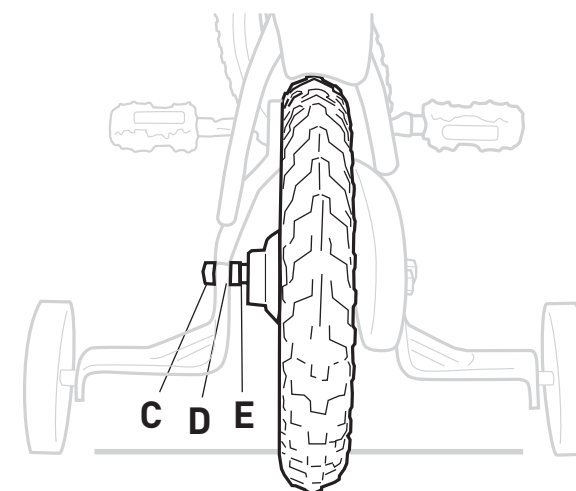

### CHAIN ADJUSTMENT

To adjust chain tension, turn the bicycle upside down and loosen the wheel nuts '1'. Move the wheel backwards or forwards in the slots of the chainstay end plate '2'. The chain '3' is correctly adjusted when there is a distance of approx 10mm between the chain and a straight line between the chainwheel '4' and freewheel '5', as shown in the diagram.

Adjust as shown, retighten the wheel nuts fully (recommended tightening torque 20-22Nm), ensuring that the wheel is in line with the main tube of the frame.

**IMPORTANT: If the chain is too tight or too loose the transmission may be damaged. We recommend that the wheels are not removed from the frame, except by a Raleigh Service Dealer. If for some reason the wheel is removed, ensure that the wheel nuts are tightened securely.**

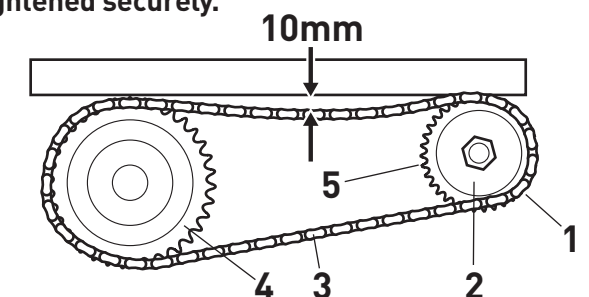

## BRAKE ADJUSTMENT

Additional tools may be required, such as a Phillips screwdriver, spanner and pliers.

### BRAKE LEVER ADJUSTMENT

This bicycle is fitted with brake levers which can be adjusted to suit your child's handgrip to give safe and comfortable operation.

The brake lever reach can be adjusted by rotating the screw '1' with a screwdriver.

Ensure that the brake levers can not rotate on the handlebar, insert screwdriver in the hole '2' to tighten.

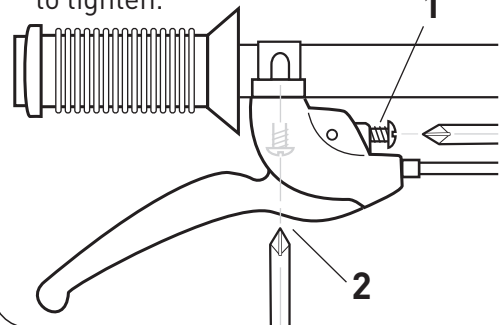

### BRAKES

**IMPORTANT: IF THE REACH IS ADJUSTED, IT MAY BE NECESSARY TO MAKE ADJUSTMENT TO THE CALIPER - REFER TO THE SECTION ON BRAKES**

To provide safe braking, the brakes on your child's bicycle should operate with minimum movement of the lever. However they should not be adjusted so closely that the brake blocks touch the rim without pressure on the lever.

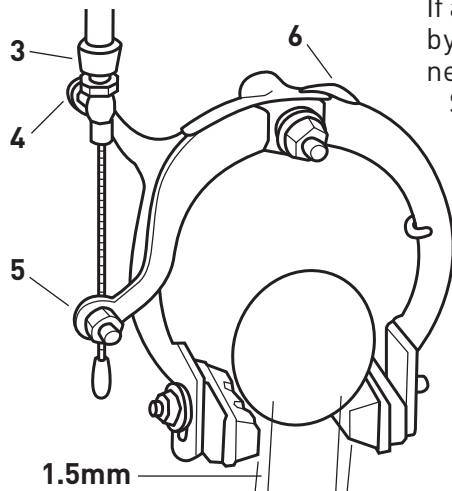

### ADJUSTMENT

Minor adjustment of the brakes can be made using the barrel adjuster. Loosen the locknut '4', turn the adjuster '3' until the brakes are set just clear of the rim. Approx 1.5mm each side. You may find it easier to turn the adjuster while holding the brake blocks against the rim, to reduce the cable tension. Remember to tighten the locknut '4' after adjustment.

If all the adjustment has been taken up by the barrel adjuster, it will be necessary to adjust the cable length.

Screw the barrel adjuster '3' half way down, tie the brake blocks against the rim with a piece of string to reduce the cable tension and undo the cable pinch bolt '5'.

Pull cable through with a pair of pliers and tighten the pinch bolt firmly. Fine adjustment can now be achieved using the barrel adjustment.

If one block is closer to the rim than the other, adjust by tapping the caliper spring '6' on the opposite side.

## PRECAUTIONS

### ADULT SUPERVISION & USER

Before each use of the bicycle:

**A.** Refer to the assembly instructions and check wheels, tyres, stabilizer fitting and brakes. Ensure all bolts are fully tightened.

**B.** Examine bicycle for damage and replace any damaged part immediately

### Weekly

Inspect brake cables for signs of fraying or wear. replace if evident. Replace annually in any case as a precaution.

### Monthly

Check as weekly, plus chain, all nuts, bolts, screws, clamps and pedals are secure.

### Yearly

We recommend that your child's bicycle is fully serviced by an approved Raleigh Service Dealer at least once a year.

### Adult Supervisor and User Precautions

Ensure the child (user) is appropriately dressed.

Never use on hills, slopes, roads or where vehicles or animals may have access or be present. Never use in kitchens or in any area adjoining stairs, steps, kerbs or patio windows.

Only use on obstruction free smooth

level and uniform carpeted, tiled, tarmac, concrete or lawned surfaces.

Ensure the user can sit on the bicycle un-aided.

Never allow more than one child to use the bicycle at one time.

Ensure the user always looks in the direction the bicycle is travelling and takes care to avoid other children or unforeseen obstruction.

Never allow the user to put any part of the bicycle in his or her mouth or to attempt to put any part of his or her body, or any plaything into any moveable or moving part of the bicycle or between any part of the bicycle and the tyres, wheels, mudguards, chainguard, chain or brake components. Instruct the user accordingly.

When re-adjusting the handlebars or seat always observe assembly instructions.

Always carry out the routine safety checks and maintenance

Wet conditions impair the braking efficiency of all bicycles. Take care.

### Working Instructions

Observe the precautions above.

Carefully seat the child on the fully assembled and checked bicycle. Straighten the child's legs to check that

soles of both feet touch the ground whilst the child is seated. Refer to assembly instructions if saddle requires adjustment.

Check the child is comfortably positioned then place the child's feet on two pedals.

Stand to one side of the bicycle and assist the child by gripping the rear of the saddle with one hand and the handlebars with the other and gently move and steer the bicycle forward.

Demonstrate the steering to the child until he or she has mastered the function and operation. The stabilisers protrude at the rear of the bicycle and the child should be taught to steer accordingly.

Demonstrate the function and operation of the brake, and finally the pedals to drive the bicycle forward.

It will take a little time for the child to master and then coordinate each operation. Similarly it may take time for the child's muscles to develop sufficiently to carry out all the operations. Only when the child has reached these stages and is able to balance the bicycle with the aid of stabilisers should the child be allowed to use the bicycle unassisted, though not unsupervised.

## MAINTENANCE & CLEANING

### LUBRICATION

In order that your child's bicycle remains in top working condition, it is important to lubricate the parts shown. This should be done when the bicycle is new and at regular intervals. We recommend using cycle oil.

**IMPORTANT: Do not overlubricate. Wipe clean any spills or excess. Never lubricate the brake blocks or rims. Never allow children access to the lubricant.**

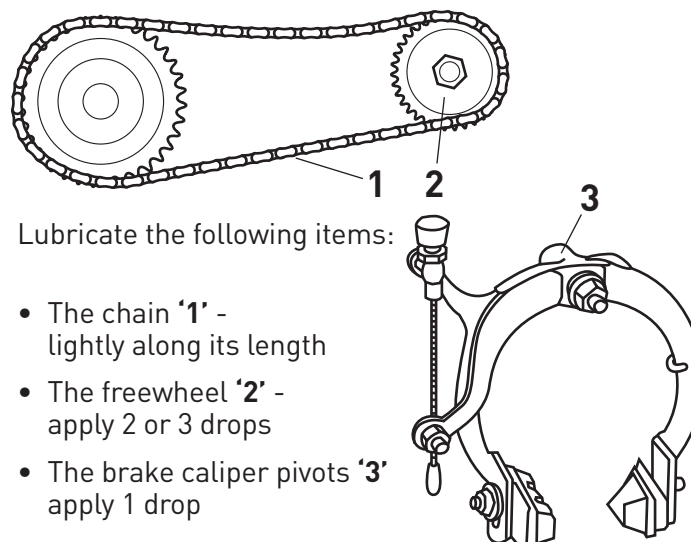

Lubricate the following items:

- The chain '1' - lightly along its length
- The freewheel '2' - apply 2 or 3 drops
- The brake caliper pivots '3' - apply 1 drop

### TYRES

It may be necessary to inflate the tyres on your child's bicycle before it is ready to ride. Recommended tyre pressures are moulded on the sidewall of the tyre.

**WARNING: Do not use a garage airline to inflate the bicycle tyres, there is a risk of serious injury.**

### CLEANING

To clean the chrome and enamel parts, use warm soapy water, rinse with clean water and finish with a dry duster. Keep the chain free from dirt by regularly wiping down with a lint free rag. You may find a stiff paintbrush useful for cleaning between the links.

### STORAGE

When not in regular use the bicycle should be stored upside down to protect the tyres. If storage is to be for some time, metal parts should be smeared lightly with grease. Be sure to remove oil or grease from the wheel rims before the bike is used again.

# RALEIGH Junior Pavement Cycle

## Owners Manual & Assembly Instructions

### SUPPLIED WITH YOUR BIKE

#### Parts bag contains:

- 1 x Spanner
- 1 x Allen key
- 2 x Stabilisers
- 2 x Pedals

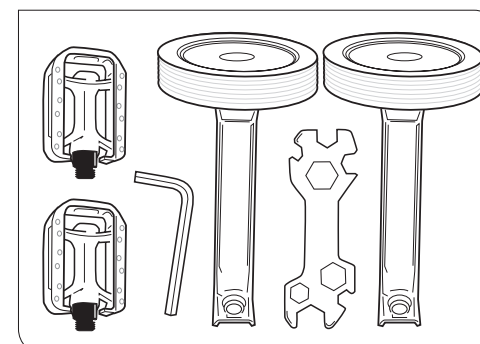

This product must be assembled by an adult. Not suitable for children under 3 years old.

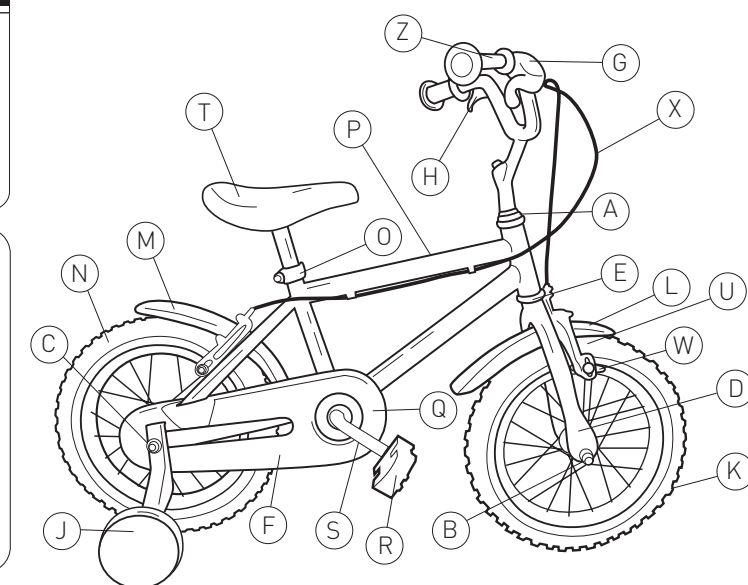

#### Parts List

- A. Head parts
- B. Front wheel nut
- C. Rear wheel nut
- D. Front fork
- E. Head bushing
- F. Chain
- G. Handlebar
- H. Front brake lever
- J. Stabilisers
- K. Front wheel
- L. Front mudguard
- M. Rear mudguard
- N. Rear wheel
- O. Saddle clamp
- P. Frame
- Q. Chainguard
- R. Crank and chainwheel
- S. Pedal set
- T. Saddle
- U. Front brake
- W. Brake block
- X. Brake cable
- Z. Handlebar grips

If you experience any problems whilst assembling this product please call the helpline 01773 532699

## GUARANTEE

The bicycle guarantee against manufacturing or materials defects from the date of the original purchase, for the period of one year provided the bicycle has been properly cared for, maintained and used. The guarantee does not cover normal wear and tear, alteration, accident, misuse, neglect, improper maintenance or commercial use (e.g. hiring). This guarantee in no way seeks to diminish your statutory rights as a customer.

Raleigh UK Ltd, Church Street, Eastwood, Nottingham NG16 3HT